

25mm Solid to 1-3/8" Male PTO Shaft Adapter

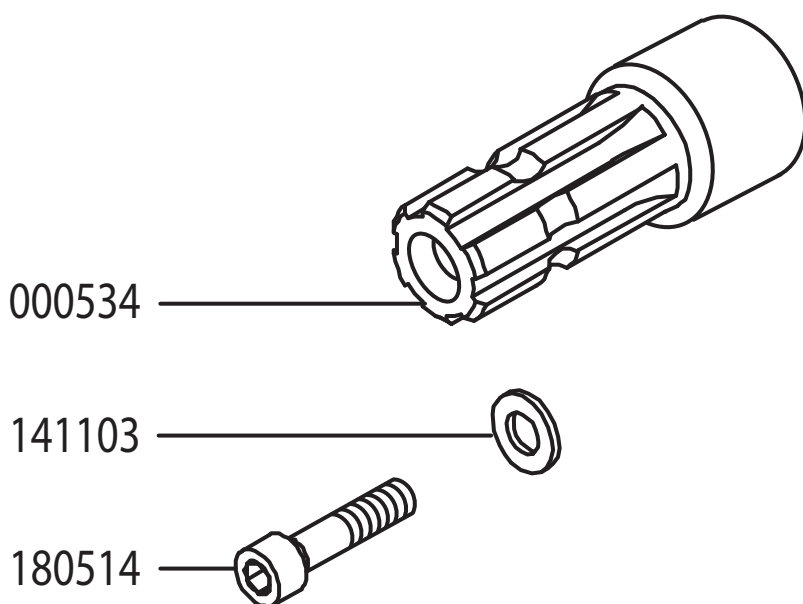

Revised 1-5-2026

| Part # | Description | Qty |
|---------|---------------------------------------|-----|
| 0005.34 | 25mm to 1-3/8" Male PTO Shaft Adapter | 1 |
| 1411.03 | Serrated Washer D10 | 1 |
| 1805.14 | Allen Bolt M10x60 | 1 |

INSTALLATION INSTRUCTIONS

NOTE: USE BLUE THREADLOCKER OR EQUIVALENT ON ALL BOLTS.

Attach the shaft to the pump crankshaft using the (1) allen bolt (1805.14) and serrated washer (1411.03).

NOTE: Adequate protection must be provided in guarding around ALL moving parts, including belts, shafts, pulleys, and drive couplers.