

Remote Mounted Adjustable Pressure Regulator

Maximum Flow	45.0 GPM / 170 lpm
Maximum Pressure	725 PSI / 50 bar
Inlet Port - Hose Barb	3/4" MPT
Outlet Ports - Hose Barb, Valve	(2) 1/2" MPT
Bypass - Hose Barb	1" HB

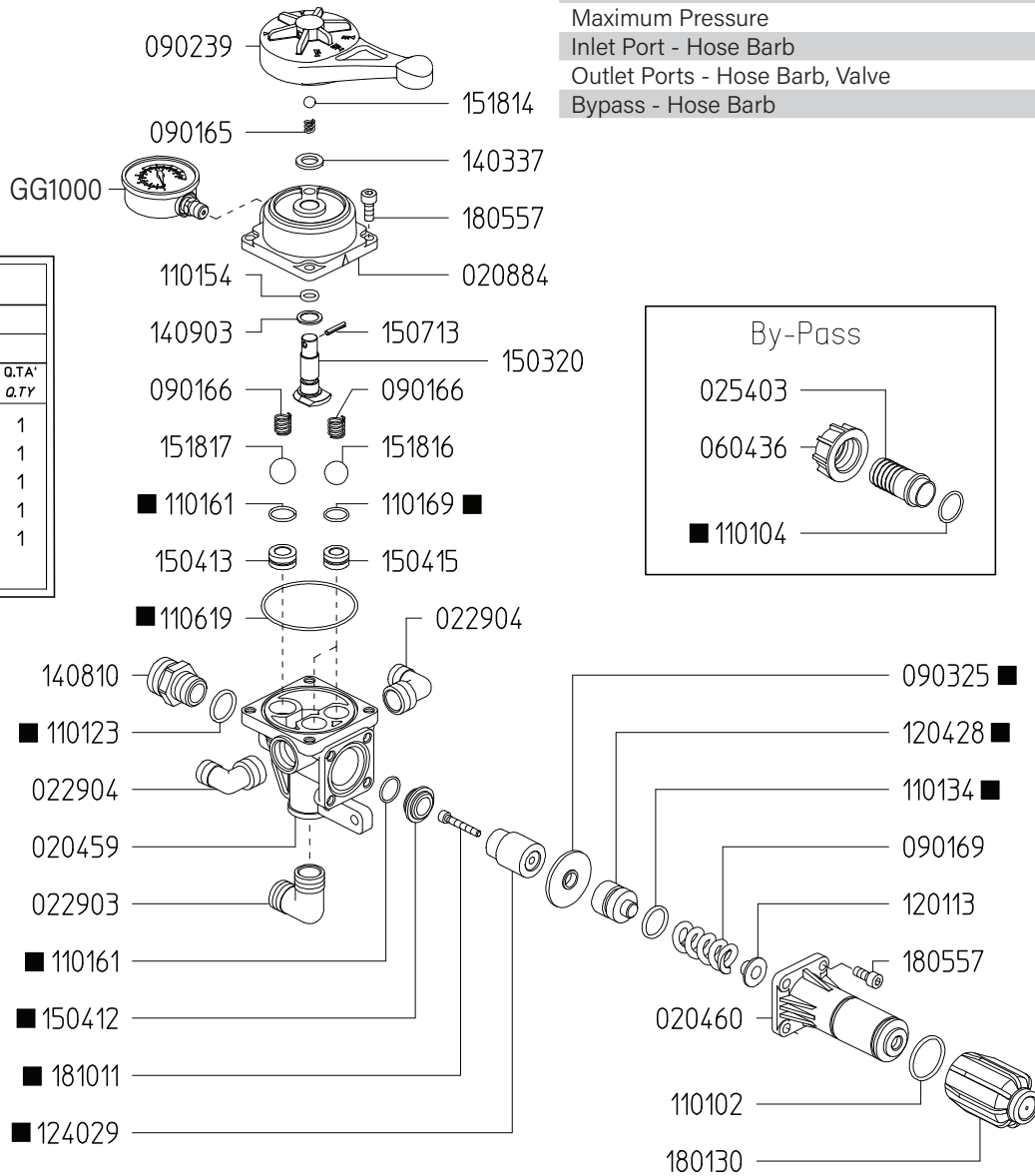

6062B7			
KIT 615			
CODICE CODE	Q.TA' Q.TY	CODICE CODE	Q.TA' Q.TY
090325	1	110619	1
110104	1	120428	1
110123	1	120429	1
110134	1	150412	1
110161	2	181011	1
110169	2		

Revised 6-6-2024

Part #	Description	Qty
0204.59	VALVE BODY	1
0204.60	REG. VALVE BODY "UHP"	1
0208.84	COVER "UHP"	1
0229.03	INLET FITTING - ELBOW G3/4 M - G3/4 M	1
0229.04	DISCHARGE FITTING - ELBOW G1/2 M - G3/4 M	2
0254.03	BY-PASS HOSE BARB	1
0604.36	NUT - BY-PASS BARB	1
0901.62	SPRING	1
0901.66	SPRING	2
0901.69	SPRING	1
0902.39	HANDLE	1
0903.25	DIAPHRAGM "UHP" D51 ■	1
1101.02	O-RING	1
1101.04	O-RING - BY-PASS BARB ■	1
1101.23	O-RING - BY-PASS ADAPTER ■	1
1101.34	O-RING ■	1
1101.54	O-RING	1
1101.61	O-RING ■	3
1106.19	O-RING ■	1

Part #	Description	Qty
1201.13	PLATE "UHP/LA"	1
1204.28	POPPET "UHP" ■	1
1204.29	POPPET "UHP" ■	1
1403.37	WASHER	1
1408.10	BY-PASS ADAPTER	1
1409.03	BACK-UP RING	1
1503.20	STEM	1
1504.12	VALVE SEAT "UHP" ■	1
1504.13	SEAT	2
1507.13	ROLL PIN	1
1518.14	BALL	1
1518.17	BALL	2
1801.30	KNOB - ADJUSTMENT	1
1805.57	ALLEN BOLT M8X22	4
1805.59	ALLEN BOLT M4X10	4
1810.11	BOLT, SS M6X40 ■	1
GG1000	PRESSURE GAUGE - 1000 PSI, BTM MOUNT	1
6062.B7	REPAIR KIT FOR UHP REGULATOR (KIT 615)	

■ Parts Included in Repair Kit 6062.56



6004.51 Dimensions

Remote Mounted Adjustable Pressure Regulator

Maximum Flow	45.0 GPM / 170 lpm
Maximum Pressure	725 PSI / 50 bar
Inlet Port - Hose Barb	3/4" MPT
Outlet Ports - Hose Barb, Valve	(2) 1/2" MPT
Bypass - Hose Barb	1" HB

