

## Adjustable Pressure Regulator

Maximum Flow	32.0 GPM / 120 l/min
Maximum Pressure	580 PSI / 40 bar
Inlet Port - Hose Barb	3/4" HB
Outlet Ports - Hose Barb, Valve	(3) 1/2" HB
Bypass - Hose Barb	1" HB

<b>606256</b>	
<b>KIT 555</b>	
<b>CODE</b>	<b>QTY</b>
090326	1
110104	1
110141	3
110166	1
110167	1
110609	1
120419	1
150129	1
181001	1

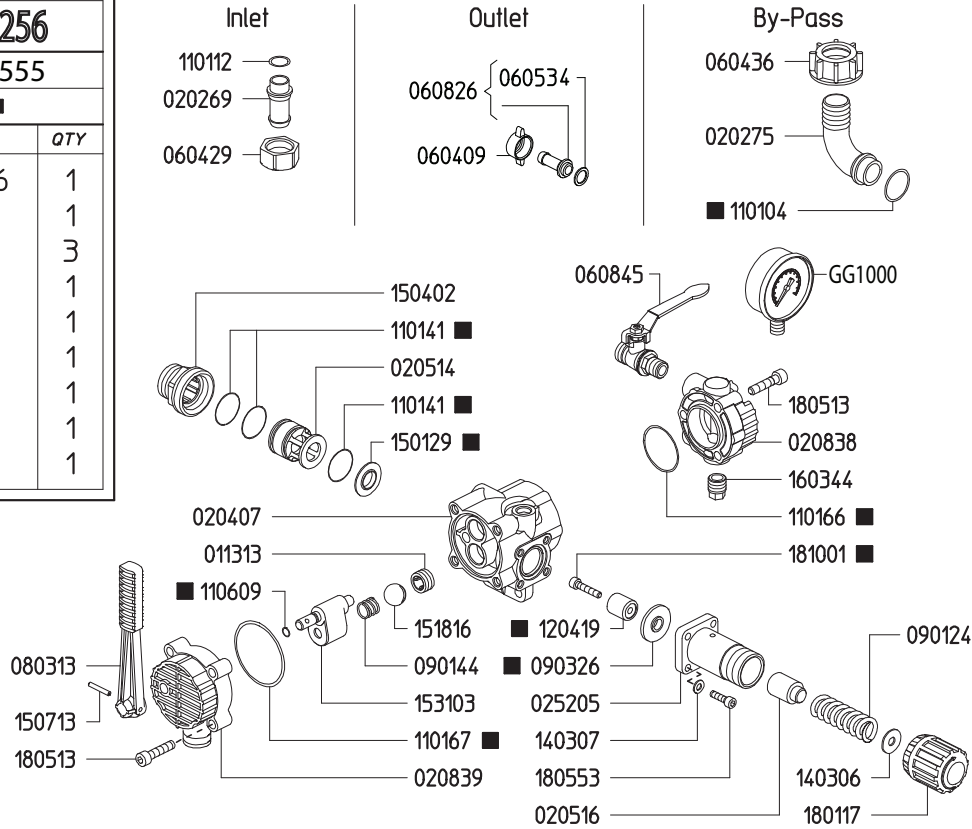

Revised 6-5-2024

Part #	Description	Qty
0113.13	BALL SEAT	2
0202.69	3/4" BRASS BARB	1
0202.75	BYPASS HOSE BARB	1
0204.07	BODY	1
0205.14	CYLINDER	1
0205.16	SPRING GUIDE	1
0208.38	DISCHARGE PLATE	1
0208.39	SELECTOR BODY	1
0252.05	SPRING BODY	1
0604.09	DISCHARGE BARB NUT	2
0604.29	BARB NUT	1
0604.36	NUT	1
0605.34	GASKET	2
0608.26	1/2" HOSE BARB W/GASKET	2
0608.45	BALL VALVE (RIGHT)	3
0803.13	LEVER	1
0901.24	SPRING	1
0901.44	SPRING	1
0903.26	DIAPHRAGM	1
1101.04	O-RING	1
1101.12	O-RING	1

Part #	Description	Qty
1101.41	O-RING	3
1101.66	O-RING	1
1101.67	O-RING	1
1106.09	O-RING	1
1204.19	STEEL POPPET	1
1403.06	WASHER	1
1403.07	WASHER	4
1501.29	SEAT	1
1504.02	BYPASS SEAT	1
1507.13	ROLL PIN	1
1518.05	CONTROL UNIT BALL	1
1531.03	CONTROL SELECTOR	1
1603.44	PLUG	2
1801.17	ADJUSTMENT KNOB	1
1805.13	BOLT	7
1805.19	BOLT	4
1810.01	STAINLESS STEEL BOLT	1
6062.56	REPAIR KIT FOR 6004.06 CONTROL UNIT (KIT 555)	
GG1000	PRESSURE GAUGE - 1000 PSI BOTTOM MOUNT	1

■ Parts Included in Repair Kit #6062.56 (KIT 555)

The control unit features a manual dump valve, pressure control knob, glycerine filled pressure gauge, and two ball valve discharge ports.

1. Before operating or re-operating the pump move lever (0803.13) to the dump position (Right) so the pump will start at zero pressure. (Failure to do so will void the pump warranty.)
2. Turn pressure adjustment knob (1801.17) counter clockwise to relieve spring tension. This step only applies to the initial start up and is not necessary in daily operation of pump.
3. Start unit and let run until air is evacuated from the system.
4. Move lever (0803.13) to the pressure position (Left) open spray gun or spray boom and turn the pressure adjustment knob (1801.17) clockwise until desired operating pressure is achieved.