

- Heavy Duty Brass Manifold with External and Internal Bracing
- Heavy Duty Bronze or Aluminum Connecting Rods
- Large Diameter Brass or Stainless Steel Valve Caps with Increased Thread Depth
- Reinforcing Ring on Inlet and Discharge Ports
- Stainless Steel Piston Guides and Check Valves
- Heat Treated Crank Shaft
- Industrial Quality Tapered Roller Bearings
- Deeper Back Cover for Increased Oil Capacity
- 34.5 oz. Capacity Vented Oil Bath Crank Case
- 3/4" BSP-F Inlet. 3/8" BSP-F Outlet - Less Than 10 GPM
- 3/4" BSP-F Inlet. 1/2" BSP-F Outlet - 10 GPM and Above
- Max Fluid Temp, 160°F

### CKC Series 24mm Keyed Solid Shaft Plunger Pumps

CKC Series super duty plunger pumps include a wide range of models with flow rates from 4.5 to 13.2 GPM and pressures up to 5075 PSI.

Other drive options include gas engine gear reduction and hydraulic motor flange.

Applications include general pressure cleaning, sewer jetting, vehicle wash equipment, street cleaning, construction, hydro-excavation and UHP fire fighting applications.

|             | Model              | Flow |       | Pressure |      | Plunger Dia. | Crankshaft |           | Power     | Seal Kit | Valve Kit | Wt.    |
|-------------|--------------------|------|-------|----------|------|--------------|------------|-----------|-----------|----------|-----------|--------|
|             |                    | GPM  | l/min | PSI      | bar  |              | Stroke     | Code      |           |          |           |        |
| 1450 RPM    | CKC 17/30 S        | 4.5  | 17.0  | 4350     | 300  | 22mm         | 11.0mm     | P         | 13.1 EBHP | 6061.10  | 6061.03   | 39 lbs |
|             | CKC 17/36 S        | 4.5  | 17.0  | 5075     | 360  | 20mm         | 13.5mm     | N         | 15.3 EBHP | 6061.D4  | 6061.63   | 39 lbs |
|             | CKC 21/30 S        | 5.5  | 21.0  | 4350     | 300  | 22mm         | 13.5mm     | N         | 16.2 EBHP | 6061.10  | 6061.03   | 39 lbs |
|             | CKC 21/36 S        | 5.5  | 21.0  | 5075     | 360  | 20mm         | 17.0mm     | X         | 18.8 EBHP | 6061.D4  | 6061.63   | 39 lbs |
|             | CKC 26/30 S        | 6.9  | 26.0  | 4350     | 300  | 22mm         | 17.0mm     | X         | 20.0 EBHP | 6061.10  | 6061.03   | 39 lbs |
|             | CKC 30/24 S        | 7.9  | 30.0  | 3480     | 240  | 25mm         | 15.0mm     | V         | 21.5 EBHP | 6061.11  | 6061.03   | 39 lbs |
|             | CKC 30/30 S        | 7.9  | 30.0  | 4350     | 300  | 22mm         | 19.0mm     | Y         | 23.1 EBHP | 6061.10  | 6061.03   | 39 lbs |
|             | <b>CKC 34/25 S</b> | 9.0  | 34.0  | 3625     | 250  | 25mm         | 17.0mm     | X         | 21.8 EBHP | 6061.11  | 6061.03   | 39 lbs |
|             | CKC 38/20 S        | 10.0 | 38.0  | 2900     | 200  | 28mm         | 15.0mm     | V         | 19.5 EBHP | 6061.12  | 6061.03   | 39 lbs |
|             | CKC 42/20 S        | 11.6 | 44.0  | 2900     | 200  | 28mm         | 17.0mm     | X         | 22.6 EBHP | 6061.12  | 6061.03   | 39 lbs |
| CKC 50/20 S | 13.2               | 50.0 | 2900  | 200      | 28mm | 19.0mm       | Y          | 25.6 EBHP | 6061.12   | 6061.03  | 39 lbs    |        |

NOTE: All pump models available with left-hand drive option. Add 'L' to model number when ordering (ex. CKC 50/20 SL)



MAX FLOW  
MAX PRESSURE  
RATED PUMP SPEED  
POWER REQUIREMENT  
LUBRICATION

9.0 GPM / 34.0 L/MIN  
3625 PSI / 250 BAR  
1450 RPM  
21.8 HP ELECTRIC  
34.5 OZ UDOR LUBE

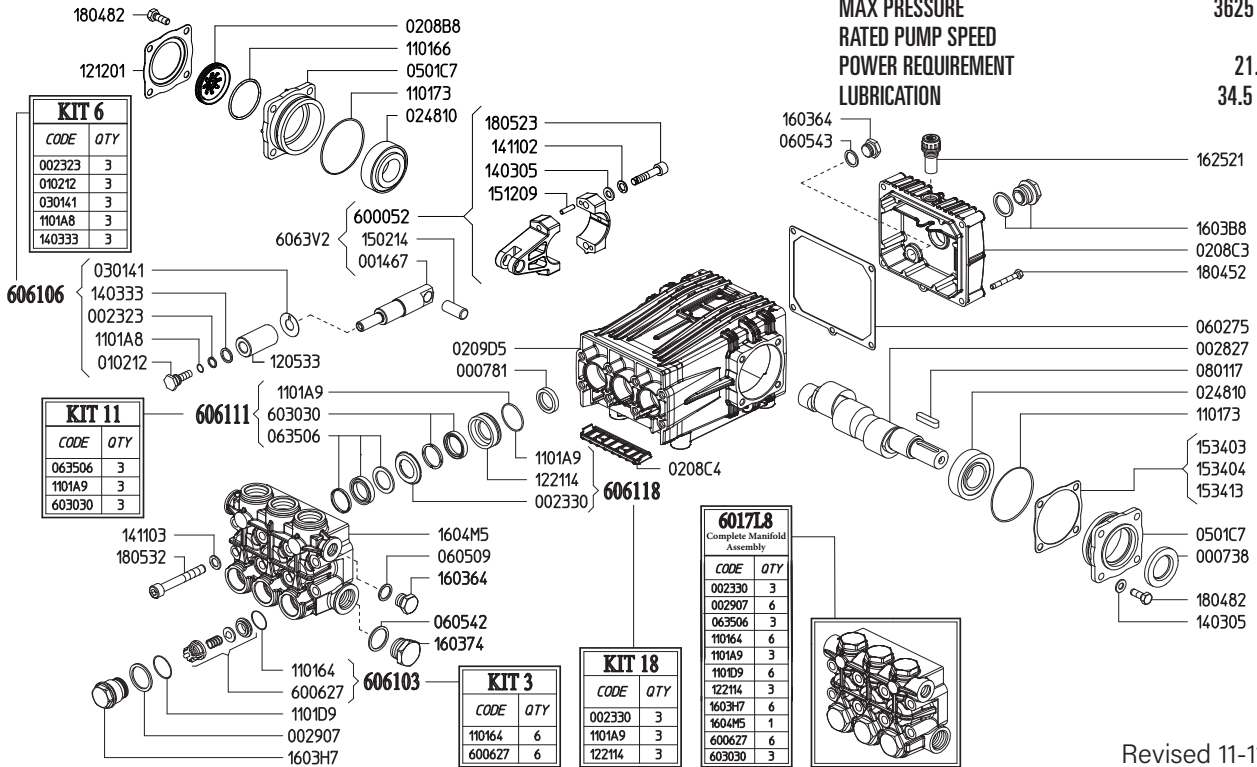

Revised 11-11-2024

| Part #  | Description                               | Qty | Part #  | Description                                | Qty |
|---------|-------------------------------------------|-----|---------|--------------------------------------------|-----|
| 0007.38 | OIL SEAL D30                              | 1   | 1403.33 | WASHER D13.4 <sup>B</sup>                  | 3   |
| 0007.81 | OIL SEAL D20                              | 3   | 1411.02 | SERATED WASHER D8                          | 6   |
| 0014.67 | PLUNGER GUIDE D22/25/28 "C/CK"            | 3   | 1411.03 | SERATED WASHER D10                         | 8   |
| 0023.23 | RING D10.4 <sup>B</sup>                   | 3   | 1502.14 | PIN D14X32                                 | 3   |
| 0023.30 | UPPER RING D25 <sup>D E</sup>             | 3   | 1512.09 | PLUG D5X20 UNI1707                         | 6   |
| 0028.27 | MALE SHAFT D24                            | 1   | 1534.03 | SHIM 0.1MM                                 | -   |
| 0029.07 | PLUG RING "CK" <sup>E</sup>               | 6   | 1534.04 | SHIM 0.2MM                                 | -   |
| 0102.12 | PLUNGER BOLT <sup>B</sup>                 | 3   | 1534.13 | SHIM 0.05MM                                | -   |
| 0208.B8 | OIL SIGHT GLASS                           | 1   | 1603.64 | PLUG G3/8                                  | 2   |
| 0208.C3 | BACK COVER "C/CK"                         | 1   | 1603.74 | PLUG G3/4                                  | 1   |
| 0208.C4 | COVER "CK"                                | 1   | 1603.B8 | OIL PLUG G3/4 + GASKET                     | 1   |
| 0209.D5 | CRANKCASE "C/CK/CH"                       | 1   | 1603.H7 | VALVE PLUG "CK" PISTON D22/25 <sup>E</sup> | 6   |
| 0248.10 | ROLLER BEARING D30                        | 2   | 1604.M5 | HEAD "CK" D22/25 <sup>E</sup>              | 1   |
| 0301.41 | SLINGER RING <sup>B</sup>                 | 3   | 1625.21 | OIL PLUG G3/8                              | 1   |
| 0501.C7 | BEARING HOLLOW FLANGE                     | 2   | 1804.52 | HEX BOLT M6X45                             | 5   |
| 0602.75 | BACK COVER GASKET                         | 1   | 1804.82 | HEX BOLT M8X22                             | 8   |
| 0605.09 | GASKET D17                                | 1   | 1805.23 | ALLEN BOLT M8X40                           | 6   |
| 0605.42 | GASKET D27                                | 1   | 1805.32 | ALLEN BOLT M10X75                          | 8   |
| 0605.43 | GASKET D17                                | 1   | 6000.52 | ROD ASSEMBLY                               | 3   |
| 0635.06 | HIGH PRESSURE SEAL KIT D25 <sup>C E</sup> | 3   | 6006.27 | VALVE ASSEMBLY W/O O-RING <sup>A E</sup>   | 6   |
| 0801.17 | KEY A8X7X35                               | 1   | 6017.L8 | COMPLETE MANIFOLD ASSEMBLY                 | 1   |
| 1101.64 | O-RING - VALVE <sup>A E</sup>             | 6   | 6030.30 | LOW PRESSURE SEAL KIT D25 <sup>C E</sup>   | 3   |
| 1101.66 | O-RING - OIL SIGHT GLASS                  | 1   | 6061.03 | KIT 3 VALVE KIT                            | 1   |
| 1101.73 | O-RING - BEARING FLANGE                   | 2   | 6061.06 | KIT 6 PLUNGER KIT                          | 1   |
| 1101.A8 | O-RING - PLUNGER BOLT <sup>B</sup>        | 3   | 6061.11 | KIT 11 WATER SEAL KIT D25 "C/CK"           | 1   |
| 1101.A9 | O-RING - PRESSURE RING <sup>C D E</sup>   | 3   | 6061.18 | KIT 18 BRASS RING KIT D25 "C/CK"           | 1   |
| 1101.D9 | O-RING - VALVE PLUG <sup>E</sup>          | 6   |         |                                            |     |
| 1205.32 | CERAMIC PLUNGER D22                       | 3   |         |                                            |     |
| 1212.01 | RETAINER - OIL SIGHT GLASS                | 1   |         |                                            |     |
| 1221.14 | PRESSURE RING D25 <sup>D E</sup>          | 3   |         |                                            |     |
| 1403.05 | WASHER D8.4                               | 14  |         |                                            |     |

<sup>A</sup> Parts in 6061.03 (Kit 3).  
<sup>B</sup> Parts in 6061.06 (Kit 6).  
<sup>C</sup> Parts in 6061.11 (Kit 11).  
<sup>D</sup> Parts in 6061.18 (Kit 18).  
<sup>E</sup> Parts in 6017.L8 (Complete Manifold Assembly).

*Dimensional Drawings are  
Shown in Millimeters.  
To Convert to Inches,  
Multiply Dimension x 0.03937*

## CK SERIES PUMPS BELOW 10 GPM

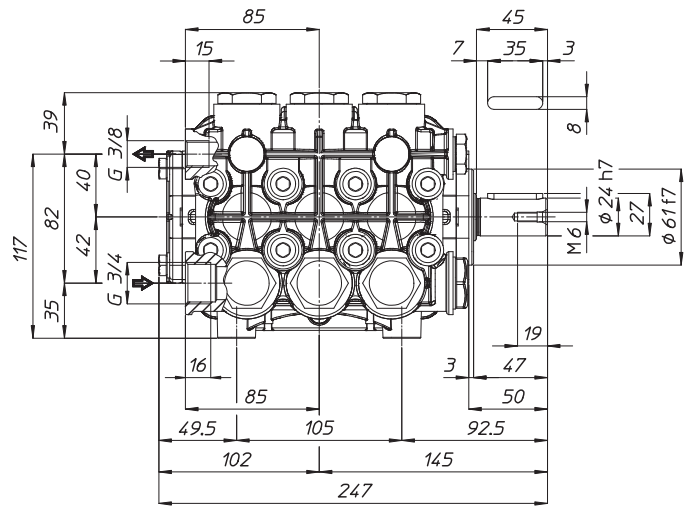

## TORQUE SPECS

| Ref. | Description          | Ft./lb. | Nm  | Loctite® |
|------|----------------------|---------|-----|----------|
| 1    | Head Bolts           | 37      | 50  | -        |
| 2    | Valve Caps           | 103     | 140 | 243      |
| 3    | Inlet Cap            | 103     | 140 | -        |
| 4    | Outlet Cap           | 103     | 140 | 243      |
| 5    | Bearing Flange Bolts | 19      | 25  | -        |
| 6    | Rear Cover Bolts     | 8       | 11  | -        |
| 7    | Connecting Rod Bolts | 19      | 25  | 270      |
| 8    | Plunger Bolts        | 15      | 20  | 270      |
| 9    | Valve Cover Bolts    | -       | -   | -        |
| 10   | Oil Drain Plug       | 8       | 11  | -        |

