

3-Cylinder, Low-Pressure Diaphragm Pumps



ZETA 70 low pressure 3-cylinder diaphragm pumps have anodized aluminum bodies with plasticized aluminum heads, stainless steel valves and glass-filled nylon manifolds.

ZETA 70 pumps are excellent for various horticultural and agricultural spraying applications.

Pumps are available with a 1-3/8" Male PTO Shaft or a 1-3/8" Male PTO x 25mm Solid Keyed Thru-Shaft.

Model	GPM	l/min	PSI	bar	RPM	Drive Configuration	Weight
ZETA 70 1C	19.0	71	300	20	550	1-3/8" 6-Spline Male PTO Shaft	21 LBS
ZETA 70 TS1C	19.0	71	300	20	550	1-3/8" 6-Spline Male PTO x 25mm Solid Keyed Thru-Shaft	21 LBS

Specifications	ZETA 70	Description	Part #
Inlet Port	1-1/4" Hose Barb	Diaphragm Kit - GREENTECH	6062.B8
Outlet Port	3/4" Hose Barb	Diaphragm Bolt & Washer Kit	6062.48
Piston Diameter	60.0mm	Valve Kit	6062.D8
Crankshaft Stroke/Code	15.0mm / T	Complete Repair Kit	8700.62CK
Dimensions	10.5"L x 10"W x 9"H		

Lubrication: Requires 20 oz. of Udor Lube 40W Premium Pump Oil.
Alternate Oil: 30W non-detergent or 15W-40 non-detergent oil.



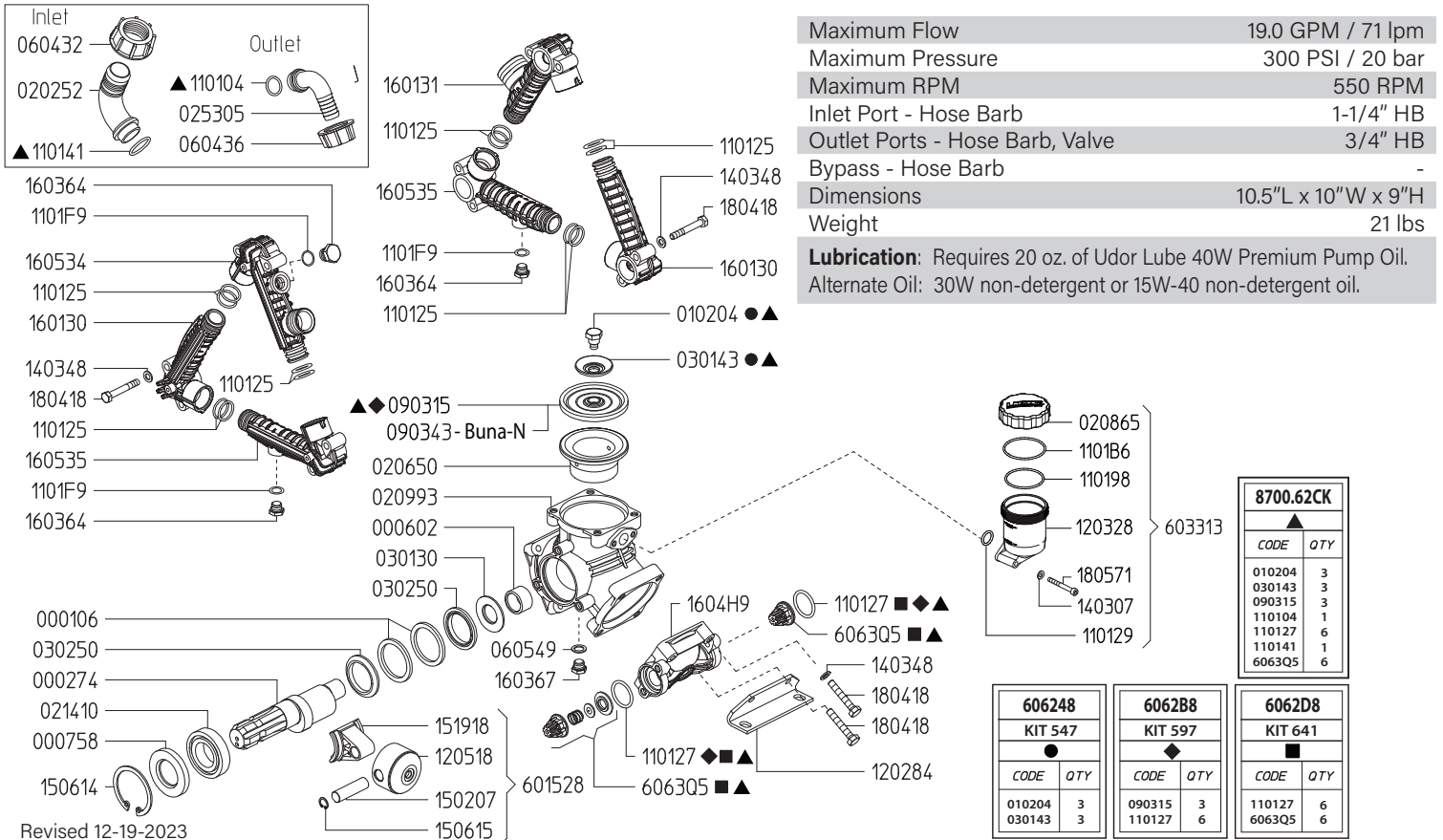

Maximum Flow	19.0 GPM / 71 lpm
Maximum Pressure	300 PSI / 20 bar
Maximum RPM	550 RPM
Inlet Port - Hose Barb	1-1/4" HB
Outlet Ports - Hose Barb, Valve	3/4" HB
Bypass - Hose Barb	-
Dimensions	10.5" L x 10" W x 9" H
Weight	21 lbs

Lubrication: Requires 20 oz. of Udor Lube 40W Premium Pump Oil.
Alternate Oil: 30W non-detergent or 15W-40 non-detergent oil.

Revised 12-19-2023

Part #	Description	Qty	Part #	Description	Qty
0001.06	RETAINER RING	2	1203.28	OIL RESERVIOR	1
0002.74	SHAFT 1C	1	1205.18	ALUMINUM PISTON D60	3
0006.02	BUSHING D25	1	1403.07	WASHER M6	2
0007.58	OIL SEAL D35	1	1403.48	WASHER M8	20
0102.04	DIAPHRAGM BOLT ●▲	3	1502.07	PIN 15X54	3
0202.52	INLET HOSE BARB D32	1	1506.14	SNAP RING D62	1
0206.50	SLEEVE D60	3	1506.15	SNAP RING D15	3
0208.65	OIL RESERVIOR CAP	1	1519.18	CONNECTING ROD	3
0209.93	CRANKCASE	1	1601.30	INLET/OUTLET MANIFOLD	2
0214.10	BALL BEARING D35	1	1601.31	SUCTION MANIFOLD G1-1/4" M	1
0253.05	OUTLET HOSE BARB D20	1	1603.64	PLUG G3/8	3
0301.30	BEARING DISC	1	1603.67	PLUG G1/4	1
0301.43	DIAPHRAGM WASHER ●▲	3	1604.H9	HEAD	3
0302.50	ROD SPACER	2	1605.34	OUTLET MANIFOLD G1" M-G3/8F	1
0604.32	BARB NUT G1-1/4"	1	1605.35	OUTLET MANIFOLD G3/8F	2
0604.36	BARB NUT G1"	1	1804.18	HEX BOLT M8X45	24
0605.49	GASKET D13	1	1805.71	ALLEN BOLT M6X50	2
0903.15	PISTON DIAPHRAGM GREENTECH 90MM ◆▲	3	6015.28	ROD ASSEMBLY D60 PISTON	3
0903.43	PISTON DIAPHRAGM BUNA-N 90MM	3	6033.13	OIL RESERVIOR ASSEMBLY	1
1101.04	O-RING - HOSE BARB▲	1	6063.Q5	VALVE ASSY W/O O-RING■▲	6
1101.25	O-RING - MANIFOLD TUBE	12	6062.48	DIAPHRAGM BOLT & WASHER (KIT 547)	1
1101.27	O-RING - VALVE ◆■▲	6	6062.B8	DIAPHRAGM KIT GREENTECH (KIT 616)	1
1101.29	O-RING - OIL RESERVIOR	1	6062.D8	IN/OUTLET VALVE KIT (KIT 641)	1
1101.41	O-RING - INLET HOSE BARB▲	1	8700.62CK	COMPLETE REPAIR KIT	1
1101.98	O-RING - OIL RESERVIOR	1			
1101.B6	O-RING - OIL RESERVIOR	1			
1101.F9	O-RING - MANIFOLD DRAIN PLUG	2			
1202.84	BASE PLATE	2			

- Parts in 6062.48 (Kit 547)
- ◆ Parts in 6062.B8 (Kit 616)
- Parts in 6062.D8 (Kit 641)
- ▲ Parts in 8700.62CK (Complete Repair Kit)

