

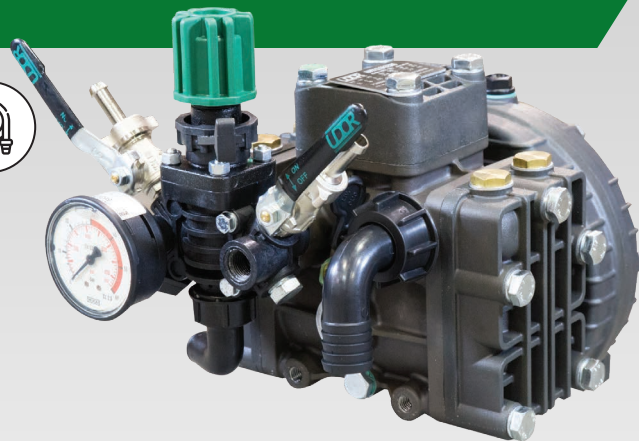

Scan this QR Code  
for more information



**KAPPA 32** 2-cylinder, medium pressure diaphragm pumps are internally manifolded with anodized aluminum construction and anodized aluminum and stainless steel liquid handling parts.

**KAPPA 32** pumps are excellent choices for various horticultural, agricultural, lawn care, nursery, pest control and turf spraying applications. They are also effectively used for aircraft de-icing, hydrostatic testing and cleaning applications.



**KAPPA 32**



**KAPPA 32 GR3/4**

Model	GPM	l/min	PSI	bar	RPM	Drive Configuration	Weight
<b>KAPPA 32</b>	9.5	36.0	560	38	550	25 mm Solid Keyed Shaft. Mounting Rails	18 LBS
<b>KAPPA 32 GR3/4</b>	9.5	36.0	560	38	550	Gear Reduction for 3/4" Shaft Gas Engine, 4-6.5 HP	28 LBS

## Specifications

## KAPPA 32

Inlet Port	1" Hose Barb
Outlet Ports	(2) 1/2" Hose Barb
Bypass	3/4" Hose Barb
Dimensions	8.5"L x 9.0"W x 9.5"H
Diaphragm Material	GREENTECH (Std) Buna-N (Opt)

**Lubrication:** Requires 20 oz. of Udor Lube 40W Premium Pump Oil.  
Alternate Oil: 30W non-detergent or 15W-40 non-detergent oil.

## QUICK REFERENCE SERVICE PARTS

Description	Part #
Diaphragm Kit (GREENTECH)	6062.C1
Diaphragm Bolt/Washer Kit	6062.B4
Valve Kit	6062.42
Regulator Repair Kit	6062.A9
Complete Repair Kit	8700.65CK

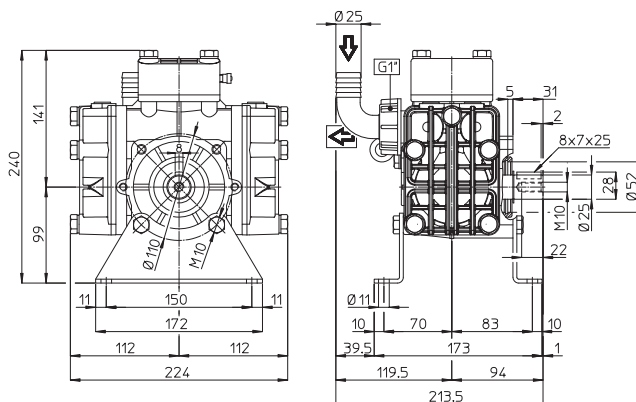

Dimensional Drawings are  
Shown in Millimeters.  
To Convert to Inches,  
Multiply Dimension x 0.03937

## Recommended Accessories and Drive Options



**6010.93**  
Control Unit  
Regulator w/Gauge



**5071.75**  
Gear Reduction  
3/4" Shaft Gas Engine



**0016.04**  
Venturi Agitator  
1/2" MNPT Inlet



**163.604.4**  
**163.604.6**  
3/8" & 1/2" HB Elbow



**UD1-16**  
1" HI-Flow Filter  
16 Mesh Screen



**15.5823**  
Udor Lube  
Premium Pump Oil