

6005.31/N CONTROL UNIT

Maximum Flow	32.0 GPM / 121 lpm
Maximum Pressure	600 PSI / 41 bar
Inlet Port - Hose Barb	3/4" Male NPT
Outlet Port	-
Bypass - Hose Barb	3/4" HB

606293	
KIT 593	
▲	
CODE	QTY
090326	1
110112	1
110135	1
120419	1
150137	1
181001	1

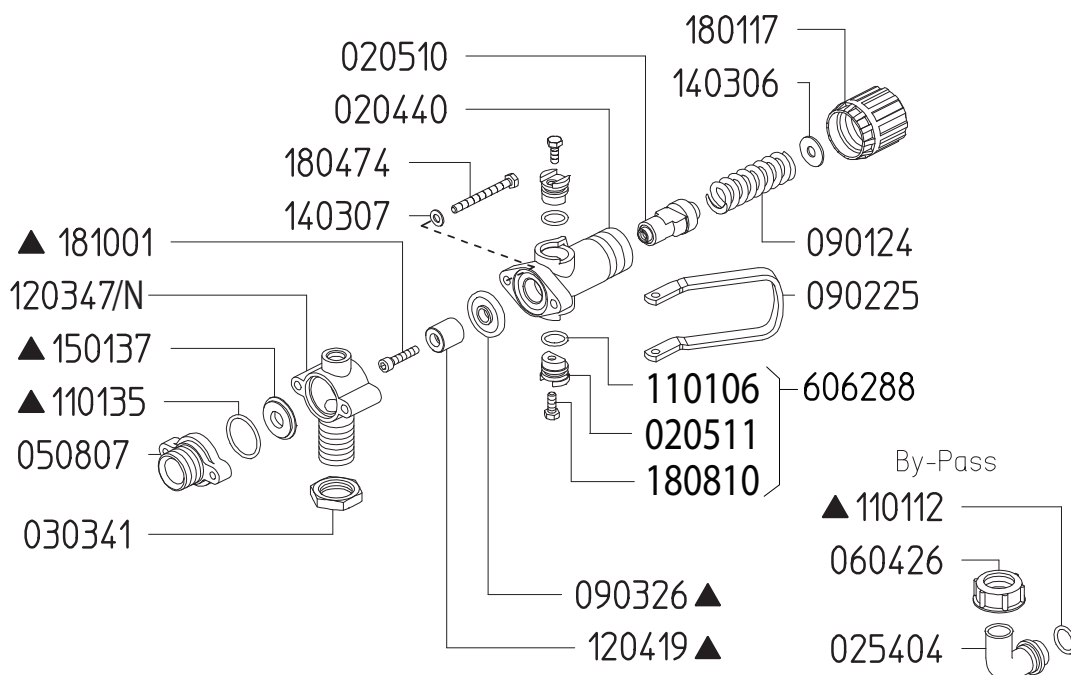

Revised 5-3-2021

Part #	Description	Qty
0202.25	BYPASS HOSE BARB - STRAIGHT (OPTIONAL)	1
0204.40	VALVE BODY	1
0205.10	VALVE CYLINDER	1
0205.11	VALVE CYLINDER CAM	2
0254.04	BYPASS HOSE BARB - ELBOW	1
0303.41	NUT	1
0508.07	BYPASS FLANGE	1
0604.26	BYPASS BARB NUT	1
0901.24	SPRING (HIGH PRESSURE)	1
0902.25	DUMP VALVE LEVER	1
0903.26	DIAPHRAGM ▲	1
1101.06	O-RING ▲	2
1101.12	O-RING ▲	1
1101.41	O-RING ▲	1

Part #	Description	Qty
1203.47/N	3/4" MNPT ELBOW (6005.31/N & 6005.31/LP-N)	1
1204.19	STEEL POPPET ▲	1
1403.06	WASHER	1
1403.07	WASHER	2
1501.37	SEAT ▲	1
1801.17	ADJUSTMENT KNOB	1
1804.74	BOLT	2
1810.01	STAINLESS STEEL BOLT ▲	1
6062.88	REGULATOR CAM KIT	2
6062.93	REPAIR KIT FOR 6005.31 CONTROL UNIT (KIT 593)	1

▲ Parts included in Repair Kit #6062.93 (KIT 593)

The control unit features a manual dump valve and pressure control knob

- Before operating or re-operating the pump, push the manual dump valve lever (0902.25) down, so the pump will start at zero pressure. FAILURE TO DO SO WILL VOID PUMP WARRANTY.
- Turn pressure adjustment knob (1801.17) counterclockwise to relieve spring tension. NOTE: Step 2 applies only to initial start-up, and is not necessary in daily operation of pump.
- Start unit and let run until air is evacuated from system, when only liquid is expelled from the bypass line.
- Return dump valve lever to the UP position. Open spray gun or spray boom and turn the pressure adjustment knob (1801.17) clockwise until desired operating pressure is achieved.