

MAX OUTPUT
RATED PUMP SPEED
POWER REQUIREMENT
LUBRICATION

10.0 GPM @ 2200 PSI
1450 RPM
15.0 HP ELECTRIC
35 OZ UDOR LUBE

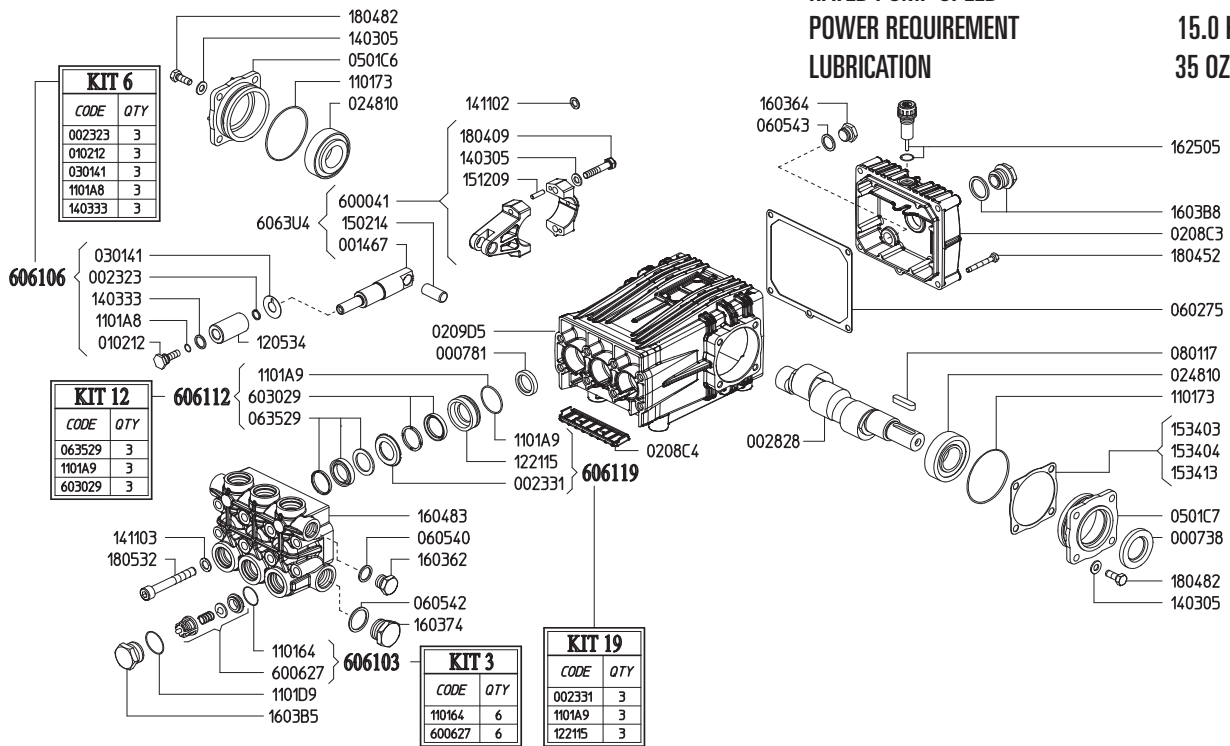

Part #	Description	Qty
0007.38	OIL SEAL D30	1
0007.81	OIL SEAL D20	3
0014.67	PLUNGER GUIDE D22/25/28 "C/CK"	3
0023.23	RING D10.4**	3
0023.31	UPPER RING D28 ****	3
0028.28	MALE SHAFT D24	1
0102.12	PLUNGER BOLT **	3
0208.C3	BACK COVER "C/CK"	1
0208.C4	COVER "C/CK"	1
0209.D5	CRANKCASE "C/CK/CH"	1
0248.10	ROLLER BEARING D30	2
0301.41	DISC**	3
0501.C6	BEARING CLOSED FLANGE	1
0501.C7	BEARING HOLLOW FLANGE	1
0602.75	BACK COVER GASKET	1
0605.09	GASKET D17	1
0605.42	GASKET D27	1
0605.43	GASKET D17	1
0635.29	HIGH PRESS SEAL KIT D28***	3
0801.17	KEY A8X7X35 UNI6604	1
1101.17	O-RING D22.23 (RIF.130)	6
1101.64	O-RING D20.24 (RIF 3081) 90SHORE*	6
1101.73	O-RING D67.95 (RIF.3268)	2
1101.A8	O-RING D9.25 (RIF.2037)**	3
1101.A9	O-RING D37.77 (RIF.3150)***	3
1101.A9	O-RING D37.77 (RIF.3150)****	3
1205.34	CERAMIC PLUNGER D28	3
1221.15	PRESSURE RING D28****	3
1403.05	WASHER D8.4	14

Part #	Description	Qty
1403.33	WASHER D13.4**	3
1411.02	SCHNORR WASHER D8	6
1411.03	SCHNORR WASHES D10	8
1502.14	PIN D14X32	3
1512.09	PLUG D5X20 UNI1707	6
1534.03	SHIM 0.1 MM	1
1534.04	SHIM 0.2 MM	1
1534.13	SHIM 0.05 MM	1
1603.64	PLUG G3/8	2
1603.74	PLUG G3/4	1
1603.84	VALVE PLUG PISTON D22/25	6
1603.B8	OIL PLUG G3/4" + GASKET	1
1604.83	HEAD "C/G" PISTON D28	1
1625.05	OIL PLUG G3/8	1
1804.09	HEX SCREW M8X40 UNI5737	6
1804.52	HEX SCREW M6X45 UNI5737	5
1804.82	HEX SCREW M8X22 UNI5739	8
1805.32	ALLEN SCREW M10X75 UNI5931	8
6000.41	ROD ASSEMBLY	3
6006.27	VALVE ASSY W/O O-RING*	6
6030.29	LOW PRESSURE SEAL KIT D28***	3
6061.03	KIT 3 VALVE KIT	
6061.06	KIT 6 PLUNGER KIT	
6061.12	KIT 12 WATER SEAL KIT D28 "C/CK"	
6061.19	KIT 19 BRASS RING KIT D28 "C/CK/NX"	

* Parts in 6061.03 (Kit 3). Not sold separately
 ** Parts in 6061.06 (Kit 6). Not sold separately
 *** Parts in 6061.12 (Kit 12). Not sold separately
 **** Parts in 6061.19 (Kit 19). Not sold separately