

Maximum Flow	68.0 GPM / 256 lpm
Maximum Pressure	300 PSI / 20 bar
Maximum RPM	540
Inlet Port - Hose Barb	2" HB
Outlet Port - Hose Barb	1-1/2" HB
Bypass - Hose Barb	-
Dimensions	14.5" L x 15.5" W x 18.5" H
Weight	80 lbs

**Lubrication:** Requires 90 oz. of Udor Lube 40W Premium Pump Oil.  
 Alternate Oil: 30W non-detergent or 15W-40 non-detergent oil.

8700.44CK		606228 KIT 527		6062D3 KIT 636		6062H4 KIT 672	
CODE	QTY	CODE	QTY	CODE	QTY	CODE	QTY
010201	6	010201	6	110101	12	090361	6
030107	6	030107	6	600677	12	110101	12
090361	6						
110101	12						
110142	1						
110193	2						
600677	12						

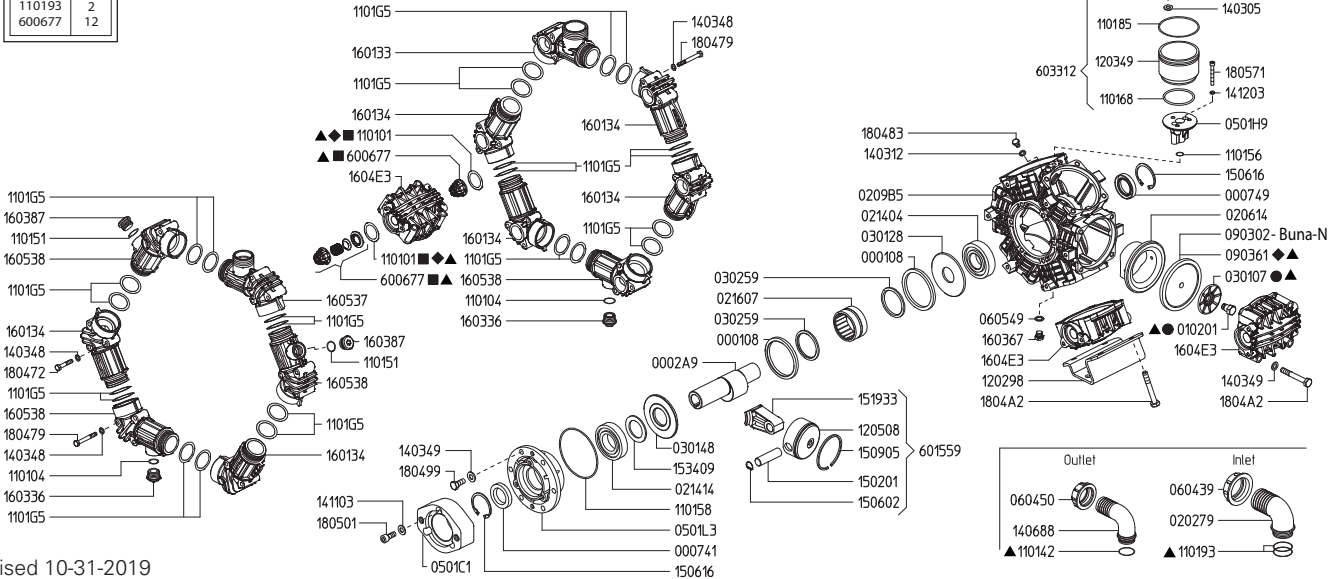

Revised 10-31-2019

Part #	Description	Qty	Part #	Description	Qty
0001.08	RETAINER RING	1	1403.48	WASHER M8	36
0002.A9	SHAFT MI D1"	1	1403.49	WASHER M10	26
0007.41	OIL SEAL D40	1	1406.88	OUTLET HOSE BARB D38	1
0007.49	OIL SEAL D35	1	1411.03	SERATED WASHER M10	3
0102.01	DIAPHRAGM BOLT ●▲	6	1412.03	BONDED WASHER M6	2
0202.79	INLET HOSE BARB D50	1	1502.01	PIN D18X64	6
0206.14	SLEEVE D75	6	1506.02	SNAP RING D18	6
0208.22	OIL RESERVOIR CAP	1	1506.16	SNAP RING D55	2
0209.B5	CRANKASE	1	1509.05	PISTON RING D75	6
0214.04	BALL BEARING D35	1	1519.33	CONNECTING ROD	6
0214.14	BALL BEARING D40	1	1534.09	DISC	1
0216.07	ROLLER BEARING D55	1	1601.33	SUCTION MANIFOLD G2"	1
0301.48	ROD DISC "ZETA 170/260" OMR80	2	1601.34	INLET-OUTLET MANIFOLD	6
0301.07	DIAPHRAGM WASHER ●▲	6	1603.36	PLUG G3/4	2
0302.59	ROD DISC	2	1603.67	PLUG G1/4	1
0501.C1	HYDRAULIC MOTOR FLANGE	1	1603.87	PLUG G3/4	2
0501.H9	OIL CUP SUPPORT FLANGE	1	1604.E3	HEAD	6
0501.L3	BEARING FLANGE	1	1605.37	OUTLET MANIFOLD G1" 1/2 M	1
0604.39	BARB NUT G2"	1	1605.38	INLET-OUTLET MANIFOLD G3/4 F	4
0604.50	BARB NUT G1-1/2"	1	1804.72	HEX BOLT M8X50	12
0605.49	GASKET D13	1	1804.79	HEX BOLT M8X70	24
0903.02	PISTON DIAPHRAGM - BUNA-N 116MM	6	1804.83	HEX BOLT M8X12	1
0903.61	PISTON DIAPHRAGM - GREENTECH 116MM ◆▲	6	1804.99	HEX BOLT M10X25	6
1101.01	O-RING - VALVE ◆■▲	12	1804.A2	HEX BOLT M10X75	24
1101.04	O-RING - DRAIN PLUG	2	1805.01	ALLEN BOLT M10X25	3
1101.42	O-RING - DISCHARGE BARB▲	1	1805.57	ALLEN BOLT M8X22	3
1101.51	O-RING - PLUG	2	1805.71	ALLEN BOLT M6X50	2
1101.56	O-RING - OIL RESERVIOR	1	6006.77	VALVE ASSEMBLY W/O O-RING ■▲	12
1101.58	O-RING - BEARING FLANGE	1	6015.59	ROD ASSEMBLY - D75 PISTON	6
1101.68	O-RING - OIL RESERVIOR	1	6033.12	OIL RESERVOIR ASSEMBLY	1
1101.85	O-RING - OIL RESERVIOR	1	6062.28	DIAPHRAGM BOLT & WASHER (KIT 527)	1
1101.93	O-RING - INLET BARB▲	2	6062.D3	IN/OUTLET VALVE KIT "ZETA 300" (KIT 636)	1
1101.G5	O-RING - MANIFOLD TUBE	24	6062.H4	DIAPHTAGM KIT - GREENTECH (KIT 672)	1
1202.98	BASE PLATE "ZETA 230/260/300"	2	8700.44CK	COMPLETE REPAIR KIT	1
1203.49	OIL RESERVOIR	1			
1205.08	ALUMINIUM PISTON D75	6			
1403.05	WASHER M8	1			
1403.12	GASKET D8.5	1			

- Parts in 6062.28 (Kit 527)
- Parts in 6062.D3 (Kit 636)
- ◆ Parts in 6062.H4 (Kit 672)
- ▲ Parts in Kit 8700.44CK



# ZETA 230/260 DIMENSIONS

All Dimensions are WITHOUT Control Unit or Regulator

Dimensional Drawings are Shown in Millimeters. To Convert to Inches, Multiply Dimension x 0.03937

Specifications	ZETA 230	ZETA 260
Inlet Port - Hose Barb	2" HB	2" HB
Outlet Ports - Hose Barb	1-1/2" HB	1-1/2" HB
Dimensions - Pump Only	14.5"L x 15.5"W x 18.5"H	
Diaphragm Material	GREENTECH (Std) Buna-N (Opt)	

**Lubrication:** Requires 39 oz. of Udor Lube 40W Premium Pump Oil.  
Alternate Oil: 30W non-detergent or 15W-40 non-detergent oil.

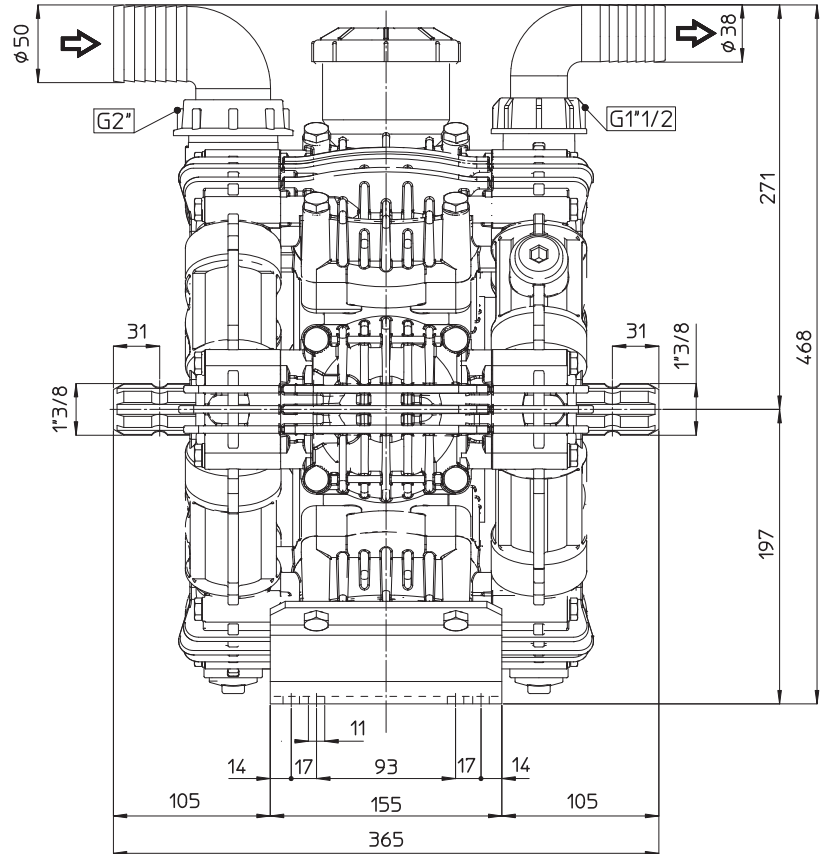
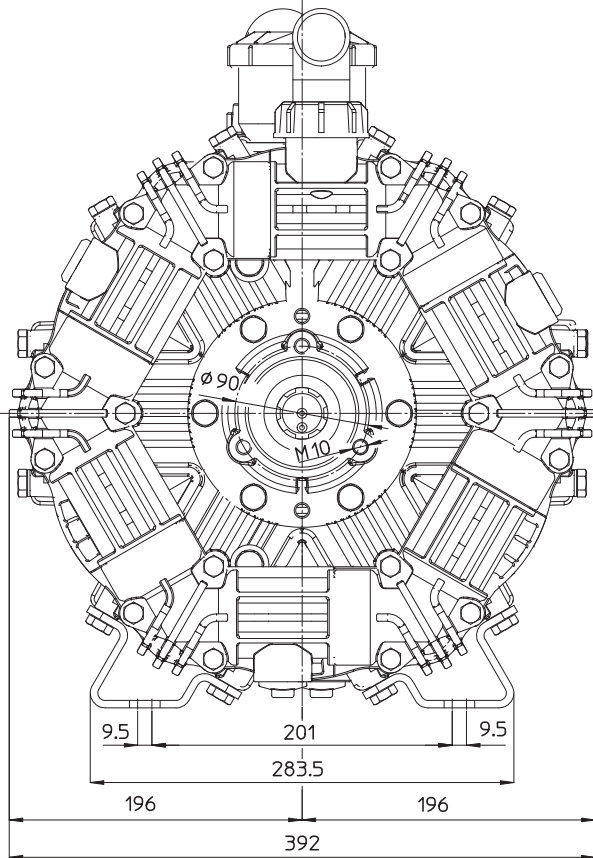

## TORQUE SPECS

Ref.	Description	Ft./lb.	Nm
1	Diaphragm Bolts (Use Loctite 243)	22	30
2	Head Bolts	30	40
3	Pulsation Dampener Bolts	18	25
4	Oil Cup Bolts	6	8
5	Manifold Bolts (Plastic)	14	20
NS	Bearing Flange Bolts (not shown)	25	34

